

Quick Connect Power Steering Fitting

Seal Replacement

If a leak occurs between the tubing and tube nut, replace the power steering pressure hose (3A719)/power steering return hose (3A713) as an assembly. If a leak occurs between the tube nut and the pump outlet, replace the Teflon® seal.

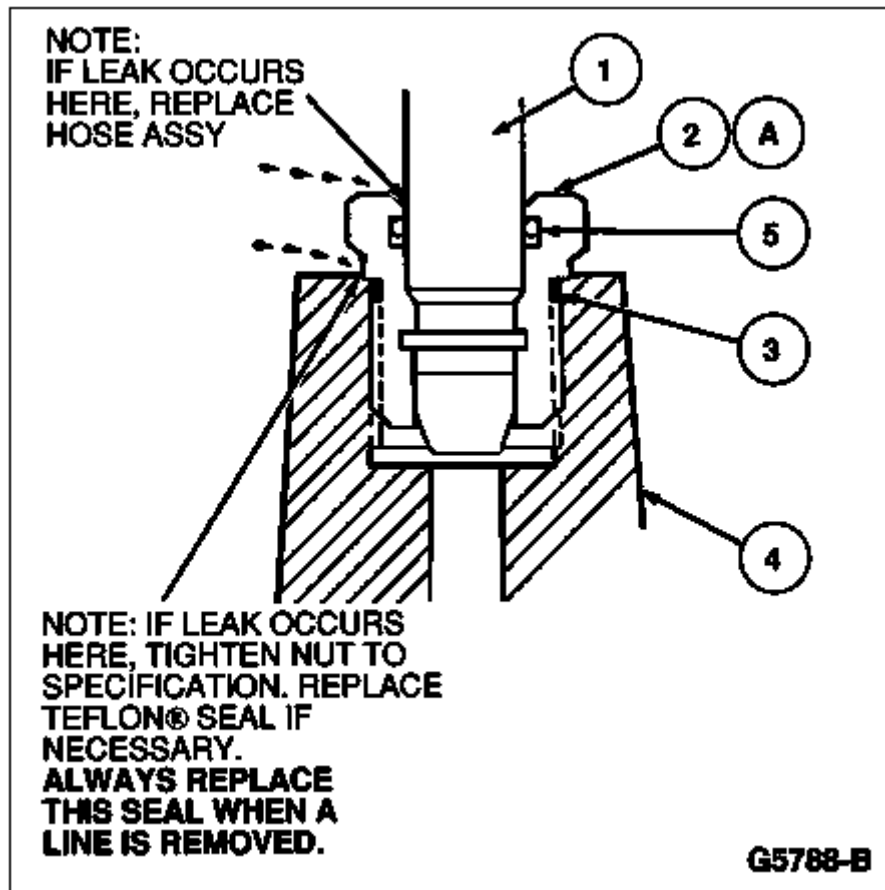

Item	Part Number	Description
1	3A719	Power Steering Pressure Hose
2	3D654	Power Steering Pump Valve Outlet Fitting (Gold)
3	388898-S	Teflon® Seal
4	3D654	Power Steering Pump Valve Outlet Fitting
5	—	O-Ring (Part of 3D593 Kit)
A	—	Tighten to 57-73 Nm (42-53 Lb-Ft)

The following procedure should be used:

1. Check fitting to determine whether leak is between tube and tube nut or between tube nut and power steering pump outlet.
2. If leak is between tube nut and power steering pump outlet, check that nut is tightened to 57-73 Nm

(42-53 lb-ft).

3. If leak continues or if leak is between tube and tube nut, remove power steering pressure hose/power steering return hose.
4. Unscrew tube nut and inspect plastic seal washer. Always replace plastic seal washer (388898-S) when power steering pressure hose/power steering return hose is removed. To facilitate assembly of new plastic seal washer, a tapered shaft such as a Teflon Seal Installer D90P-3517-A or equivalent may be required to stretch washer, so it may be slipped over tube nut threads.

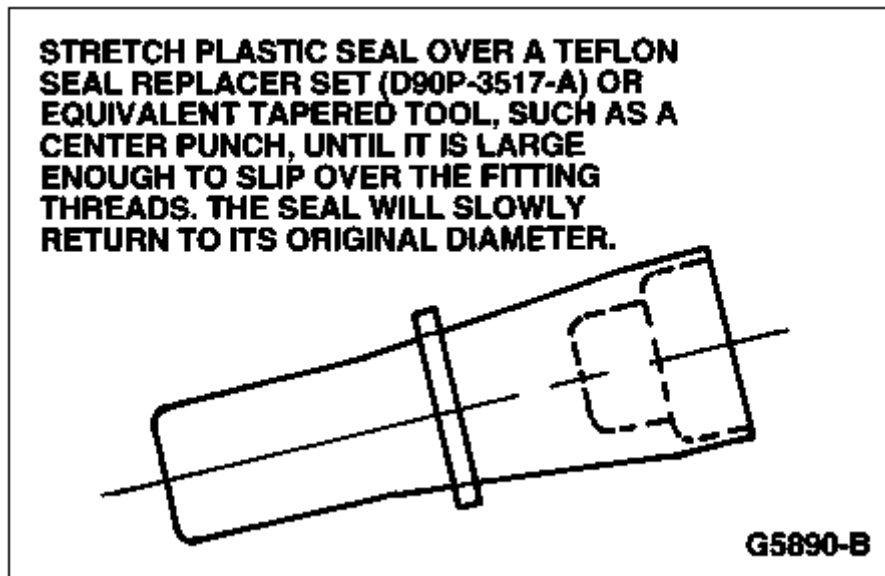

5. The rubber O-ring cannot be serviced with this design. If leak is due to the O-ring, replace the power steering pressure hose/power steering return hose and tube nut.
6. Connect tube nut and tighten to 57-73 Nm (43-53 lb-ft).

The quick connect fitting may disengage if not fully assembled, if the snap ring is missing, or if the tube nut or the hose end is not machined properly.

If the fitting disengages, replace the power steering pressure hose/ power steering return hose. The fitting is fully engaged only when the power steering pressure hose/power steering return hose will not pull out. To test for positive engagement, the system should be properly filled, the engine started, and the steering wheel cycled from lock-to-lock. Service power steering pressure hose/power steering return hose assemblies have tube nuts, snap rings and O-rings already connected.

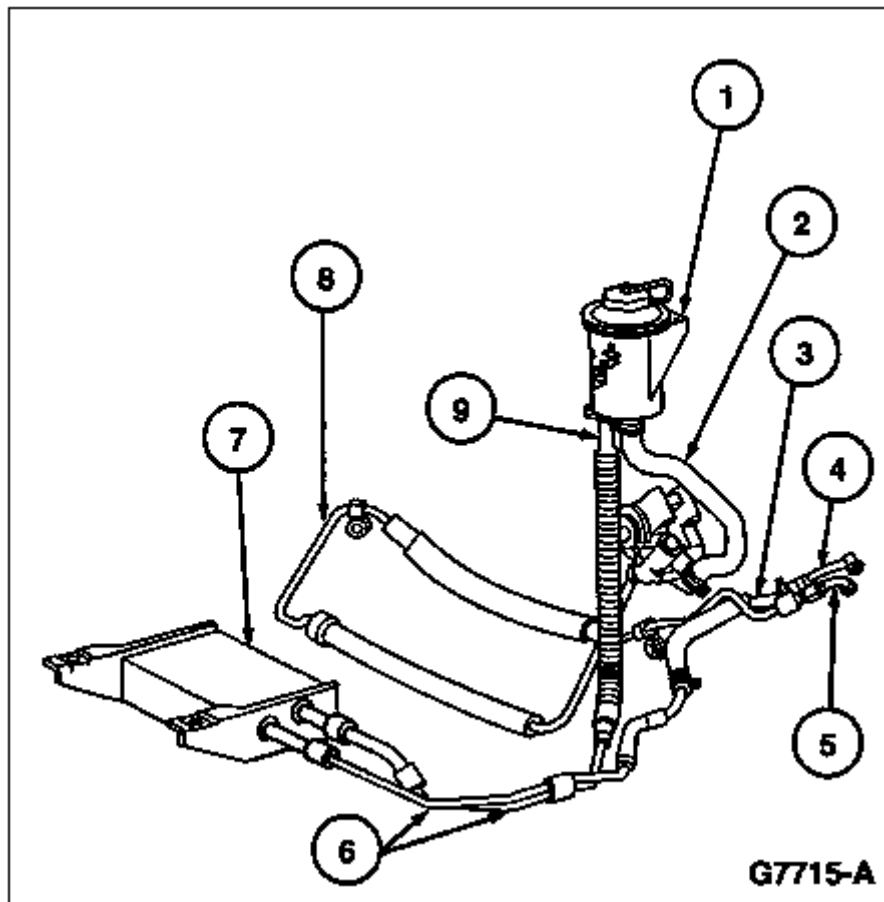

Item	Part Number	Description
1	3E764	Power Steering Pump Reservoir
2	3691	Power Steering Reservoir Pump Hose
3	3A713	Power Steering Return Hose
4	3A563	Power Steering Return Tube
5	3E576	Power Steering Pressure Tube
6	3F558	Power Steering Hose
7	3D746	Power Steering Fluid Cooler
8	3A714	Power Steering Left Turn Pressure Hose
9	3493	Return Hose